

6

5

4

3

2

1

MATERIAL AND FINISH:

Insulator: Polycarbonate, UL-94V-0 rated
Contacts: Brass

ELECTRICAL SPECIFICATIONS:

Current rating: 10 A/15 A
Voltage rating: 250 VAC
Insulation resistance: 100 Mohm min. at 500 VDC
Dielectric withstanding voltage: 2000 VAC for one minute

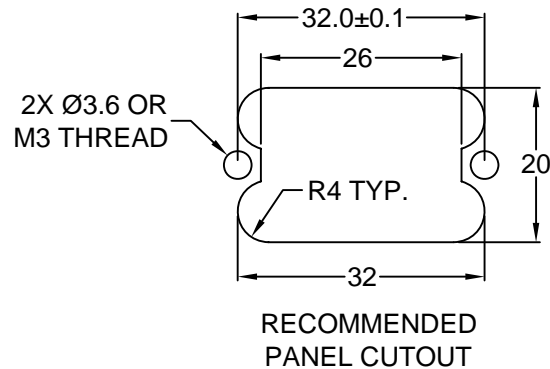
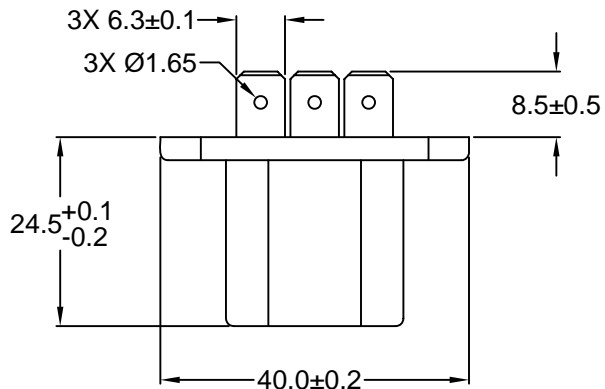

ORDERING CODE:

43R05-1 3
 1 2

- 1) COLOR
1 = BLACK
2 = GRAY

2) ELECTRICAL CIRCUIT CONFIGURATION

- 1 = 10A 250V 70°C
15A 250V 70°C
2+GROUND
- 2 = 10A 250V 120°C
15A 250V 120°C
2+GROUND
- 3 = 10A 250V 155°C
2+GROUND

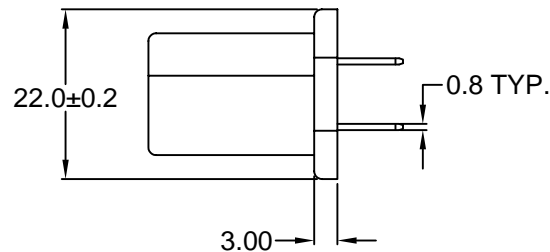
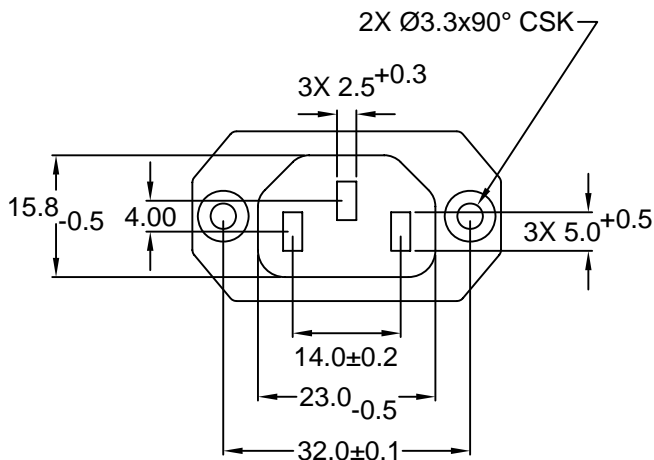

RoHS COMPLIANT

REVISIONS

REV	DATE	CHANGE	CHNG CHECK	APPR
A	11/21/05	ADD RoHS	PB	

TOLERANCE UNLESS OTHERWISE SPECIFIED	
X	± 1
X.X	± 0.4
X.XX	± 0.20
DRAWN BY	GQ
DATE:	10/08/01
CHECK BY	TD
DATE:	10/18/01
APPR BY	PB
DATE:	10/18/01

Power Dynamics, Inc.
Phone: 973 560-0019 Whippany, New Jersey Fax: 973 560-0076

PART: 10A/15A IEC 60320 APPL. OUTLET; QC
TERMINALS; SIDE FLANGE, PANEL MOUNT

43R05-1X3X

SIZE: A
SCALE: NTS

ALL DIMENSIONS FOR REFERENCE ONLY
DIMENSIONS ARE IN MILLIMETERS

SHEET 1 of 1
REV: A