

6

5

4

3

2

1

SPECIFICATIONS:

Material: Phosphor Bronze, Tin plated

Current Rating: 12A

Voltage rating: 320VAC

Contact resistance: ≤ 20mohms

Wire size: 0.5-1.5mm² / 20-16AWG

Strip length: 8 - 9mm

Operating temperature: -45°C ~ +125°C

Packaging: Tape & Reel, 1300 pcs per reel.



Note: Multi strand wire should be twisted and tin plated before inserting into connector

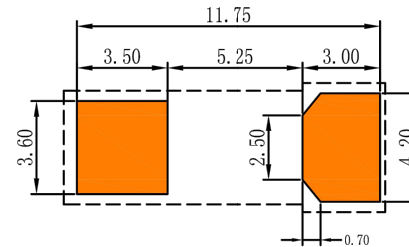
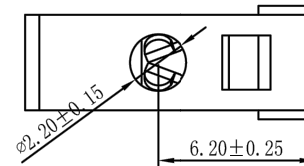
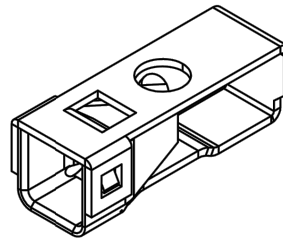
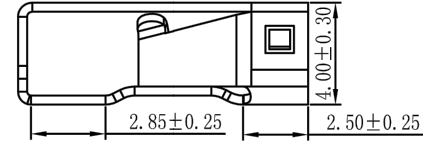
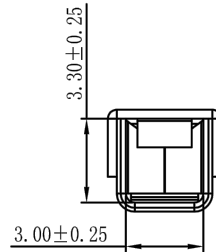
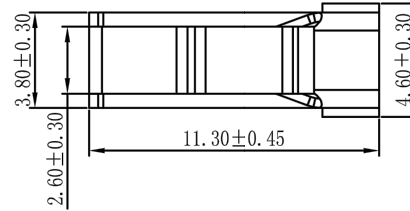

REVISIONS
CHANGE
CHK
CHK
APPR
APP
REV
DATE
BY

TOLERANCE UNLESS OTHERWISE SPECIFIED	
X	± 1
X.X	± 0.4
X.XX	± 0.20
DRAWN BY	PB
CHECK BY	-
APPR BY	-
DATE:	9/12/19
DATE:	-
DATE:	-

Power Dynamics, Inc.	
Phone: 973 560-0019 Whippany, New Jersey Fax: 973 560-0076	
PART: METAL SMD PCB TERMINAL BLOCK SINGLE POLE; FOR 20 - 16 AWG	
PART #: PD-B14B	
SIZE: A	ALL DIMENSIONS FOR REFERENCE ONLY
SCALE: NTS	REV: -

SHEET 1 of 1

6

5

4

3

2

1